

# Accessories

## Adapter R-FS type A (metric)

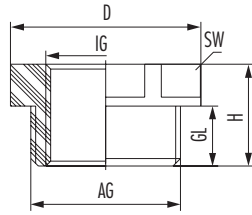

Material	Polyamide
Temperature range	-40°C to +80°C
Colour	grey
RAL	7035

RoHS

// For further sizes see type B or C

AG	IG	Type	D mm	GL mm	H mm	SW mm	Item-No
M16 x 1.5	M12 x 1.5	A	24	9	16	22	1.272.1612.50
M20 x 1.5	M16 x 1.5	A	27	9	16	24	1.272.2016.50
M25 x 1.5	M20 x 1.5	A	32	10	17	29	1.272.2520.50
M32 x 1.5	M25 x 1.5	A	40	12	19	36	1.272.3225.50
M40 x 1.5	M32 x 1.5	A	51	12	19	46	1.272.4032.50
M50 x 1.5	M40 x 1.5	A	61	14	21	55	1.272.5040.50
M63 x 1.5	M50 x 1.5	A	75	15	22	65	1.272.6350.50

Adapter R-FS type B (PG)

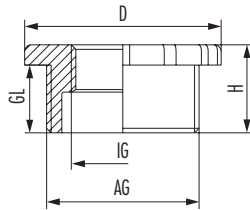

Material	Polyamide
Temperature range	-40°C to +80°C
Colour	grey
RAL	7035

RoHS

// For further sizes see type A or C

AG	IG	Type	D mm	GL mm	H mm	Item-No
PG 13.5	PG 9	B	27	8	12	1.272.1309.11
PG 16	PG 9	B	29	10	13	1.272.1609.11
PG 16	PG 11	B	29	10	13	1.272.1611.11
PG 21	PG 13.5	B	36	11	13.5	1.272.2113.11
PG 21	PG 16	B	36	11	13.5	1.272.2116.11
PG 29	PG 21	B	46	11	13.5	1.272.2921.11
PG 36	PG 29	B	58	11	15	1.272.3629.11

## Adapter R-FS type C (PG)

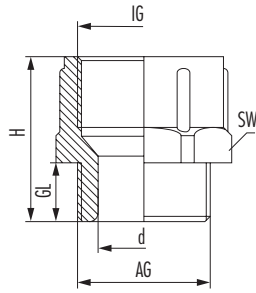

Material	Polyamide
Temperature range	-40°C to +80°C
Colour	grey
RAL	7035

RoHS

// For further sizes see type A or B

AG	IG	Type	d mm	GL mm	H mm	SW mm	Item-No
PG 9	PG 7	C	8	8	14	15	1.236.0907.11
PG 11	PG 9	C	10.2	8	23	22	1.236.1109.11
PG 13.5	PG 11	C	11.5	9	21.5	22	1.236.1311.11
PG 16	PG 13.5	C	13.5	10	27	27	1.236.1613.11

Adapter R-M-PA type A (metric, PG)

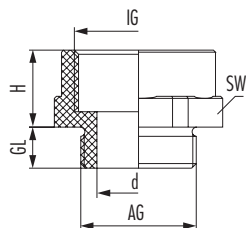

Material	Polyamide
Temperature range	-20°C to +80°C
Colour	black
RAL	9005

RoHS

// For further sizes see type B or C

AG	IG	Type	d mm	GL mm	H mm	SW mm	Item-No
M25 x 1.5	PG 16	A	18	8	14	29	1.273.2516.50
M32 x 1.5	PG 21	A	25	10	15	36	1.273.3221.50
M40 x 1.5	PG 29	A	33	10	15	45	1.273.4029.50
M50 x 1.5	PG 36	A	43	12	17	55	1.273.5036.50
PG 16	M20 x 1.5	A	16	8	13	27	1.273.1620.11

# Accessories

## Adapter R-M-PA type B (metric, PG)

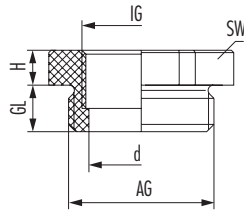

Material	Polyamide
Temperature range	-20°C to +80°C
Colour	black
RAL	9005

RoHS

// For further sizes see type A or C

AG	IG	Type	d mm	GL mm	H mm	SW mm	Item-No
M16 x 1.5	M12 x 1.5	B	10	8	6	20	1.273.1612.50
M20 x 1.5	M16 x 1.5	B	13.5	8	6	25	1.273.2016.50
M25 x 1.5	PG 13.5	B	18	8	6	29	1.273.2513.50
M25 x 1.5	M20 x 1.5	B	18	8	6	29	1.273.2520.50
M32 x 1.5	M25 x 1.5	B	23	10	6	36	1.273.3225.50
PG 13.5	M16 x 1.5	B	14	8	6	25	1.273.1316.11

Adapter R-M-PA type C (metric, PG)

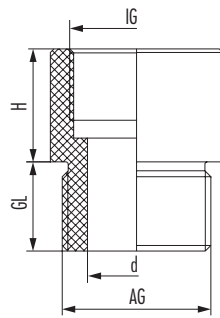

Material	Polypropylene
Temperature range	-20°C to +80°C
Colour	black
RAL	9005

RoHS

// For further sizes see type A or B

AG	IG	Type	d mm	GL mm	H mm	Item-No
M40 x 1.5	M32 x 1.5	C	30	15	5	1.273.4032.50
M50 x 1.5	M40 x 1.5	C	38	15	5	1.273.5040.50
M63 x 1.5	PG 42	C	52	15	5	1.273.6342.50
M63 x 1.5	M50 x 1.5	C	48	15	5	1.273.6350.50
PG 9	M12 x 1.5	C	8.5	15	19	1.273.0912.11
PG 11	M16 x 1.5	C	11.5	15	19	1.273.1116.11
PG 21	M25 x 1.5	C	20.5	15	19	1.273.2125.11
PG 29	M32 x 1.5	C	28	15	19	1.273.2932.11
PG 36	M40 x 1.5	C	38	15	5	1.273.3640.11
PG 42	M40 x 1.5	C	38	15	5	1.273.4240.11
PG 48	M50 x 1.5	C	38	15	5	1.273.4850.11

# Accessories

## Adapter E-M-PA type A (metric, PG)

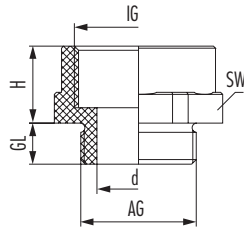

Material	Polyamide
Temperature range	-20°C to +80°C
Colour	black
RAL	9005

**RoHS**

// For further sizes see type C

AG	IG	Type	d mm	GL mm	H mm	SW mm	Item-No
M12 x 1.5	PG 7	A	6.5	8	12	17	1.239.1207.50
M12 x 1.5	M16 x 1.5	A	6.5	8	12	21	1.239.1216.50
M16 x 1.5	M20 x 1.5	A	9	8	13	25	1.239.1620.50
M20 x 1.5	PG 13.5	A	14	8	13	25	1.239.2013.50
M20 x 1.5	M25 x 1.5	A	14	8	15	30	1.239.2025.50
PG 9	M16 x 1.5	A	9	8	12	21	1.239.0916.11
PG 13.5	M20 x 1.5	A	14	8	13	25	1.239.1320.11
PG 16	M25 x 1.5	A	16	8	15	30	1.239.1625.11
PG 21	M32 x 1.5	A	21	8	15	37	1.239.2132.11
PG 29	M40 x 1.5	A	30	10	17	45	1.239.2940.11

## Adapter E-M-PA type C (metric, PG)

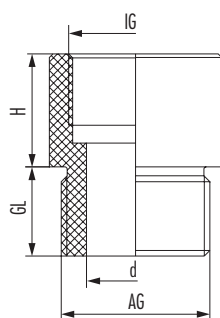

Material	Polypropylene
Temperature range	-20°C to +80°C
Colour	black
RAL	9005

**RoHS**

// For further sizes see type A

AG	IG	Type	d mm	GL mm	H mm	Item-No
M16 x 1.5	PG 9	C	8.5	1	19	1.239.1609.50
M25 x 1.5	M32 x 1.5	C	16.5	15	15	1.239.2532.50
M32 x 1.5	M40 x 1.5	C	23	15	19.5	1.239.3240.50
M40 x 1.5	M50 x 1.5	C	30	15	19.5	1.239.4050.50
M50 x 1.5	M63 x 1.5	C	39	15	20	1.239.5063.50
M63 x 1.5	PG 48	C	51	15	20	1.239.6348.50
PG 7	M12 x 1.5	C	6	15	19	1.239.0712.11
PG 11	M20 x 1.5	C	11.5	15	19	1.239.1120.11
PG 36	M50 x 1.5	C	37	15	19.5	1.239.3650.11
PG 42	M50 x 1.5	C	43	15	19.5	1.239.4250.11
PG 48	M63 x 1.5	C	48	15	20	1.239.4863.11



# Accessories

## Adapter K-FS (PG)

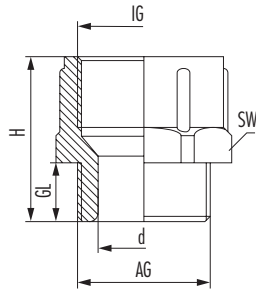

Material	Polyamide
Temperature range	-20°C to +80°C
Colour	grey
RAL	7035

RoHS

AG	IG	Type	d mm	GL mm	H mm	SW mm	Item-No
PG 11	PG 13.5	B	12.5	8	15	24	1.233.1113.11
PG 13.5	PG 16	B	15	9	16	27	1.233.1316.11
PG 16	PG 21	B	16	10	19	32	1.233.1621.11
PG 21	PG 29	B	22.5	11	21	42	1.233.2129.11