

Ex ACCESSORIES

Cable glands for explosion protection areas also demand accessories specifically designed for those areas. HUMMEL has a wide range of accessories specially developed for this sector. These accessories meet all the requirements for Ex-areas and are backed up by all the necessary certification and approvals.

- // Accessories in plastic, brass and stainless steel
- // Plugs with explosion area approval
- // Reduction fittings in a wide range of different sizes

The accessories come in a range of materials, sizes and thread types.



Ex Accessories

Plug V-Ex (metric, PG)

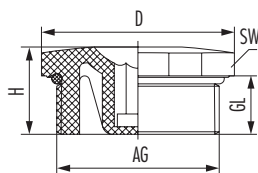

Material	Polyamide, fiber reinforced
Material o-ring	NBR
Protection class	IP 68 – 10 bar / IP 69 K
Ex-protection level	II 1D Ex ta IIIC Da / II 2G Ex e IIC Gb
Temperature range	-20°C to +90°C
Colour	black
RAL	9005

RoHS

AG	D mm	GL mm	H mm	SW mm	⊙	Item-No
M12 x 1.5	16.5	8.5	13	15	6	1.297.1201.50
M16 x 1.5	20.5	8.5	13	19	8	1.297.1601.50
M20 x 1.5	25.5	9	14.5	24	8	1.297.2001.50
M25 x 1.5	30.5	10.5	16	28	8	1.297.2501.50
M32 x 1.5	38	11.5	17.5	36	8	1.297.3201.50
M40 x 1.5	48	11.5	18	46	8	1.297.4001.50
M50 x 1.5	60	13.5	20	55	8	1.297.5001.50
M63 x 1.5	75	14.5	21	70	8	1.297.6301.50
PG 7	16.5	8.5	13	15	6	1.297.0701.11
PG 9	20.5	8.5	13	19	8	1.297.0901.11
PG 11	25.5	9	14.5	24	8	1.297.1101.11
PG 13.5	25.5	9	14.5	24	8	1.297.1301.11
PG 16	30.5	10.5	16	28	8	1.297.1601.11
PG 21	38	11.5	17.5	36	8	1.297.2101.11
PG 29	48	11.5	18	46	8	1.297.2901.11
PG 36	60	13.5	20	55	8	1.297.3601.11
PG 42	65	13.5	20	60	8	1.297.4201.11
PG 48	75	14.5	21	70	8	1.297.4801.11



to the assembly instruction



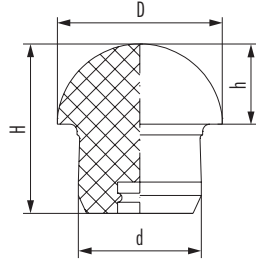

Material	Elastomer
Ex-protection level	II 1D Ex ta IIIC Da / II 2G Ex e IIC Gb
Temperature range	-40°C to +95°C
Colour	black
RAL	9005

RoHS

Suitable for AG	Suitable for AG 2	Suitable for AG 3	D mm	d mm	H mm	h mm	Item-No
PG 7	M12 x 1.5		8.5	6.3	11.5	4.5	1.296.0701.11
PG 9	M16 x 1.5	NPT 3/8"	11	7.8	13.5	5.5	1.296.0901.11
PG 11	M16 x 1.5		13.5	9.8	14.5	5.5	1.296.1101.11
PG 13.5	M20 x 1.5	NPT 1/2"	16	11.8	18	8	1.296.1301.11
PG 16	M20 x 1.5	NPT 1/2" / 16	18.5	13.8	19	9	1.296.1601.11
PG 21	M25 x 1.5	NPT 3/4"	22	17.8	22	11	1.296.2101.11
PG 29	M32 x 1.5	NPT 1" / NPT 1 1/4"	29	25	25	10	1.296.2901.11
PG 36	M40 x 1.5	NPT 1 1/2"	38	32	28	11	1.296.3601.11
PG 42	M50 x 1.5		43	38	30	12	1.296.4201.11
PG 48	M63 x 1.5		49	44	30	12	1.296.4801.11



to the assembly instruction



Plug HSK-V-Ex (MZ version)

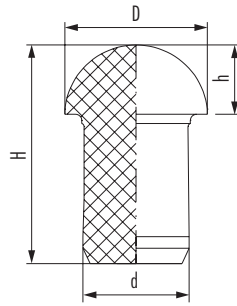

Material	Elastomer
Ex-protection level	II 1D Ex ta IIIC Da / II 2G Ex e IIC Gb
Temperature range	-40°C to +95°C
Colour	black
RAL	9005

RoHS

// This closure fits on all HSK screw fittings with additional strain relief (double bracket)

Suitable for AG	Suitable for AG 2	Suitable for AG 3	D mm	d mm	H mm	h mm	Item-No
PG 7	M12 x 1.5		8.5	6.3	18	4.5	1.296.0701.61
PG 9	M16 x 1.5	NPT 3/8"	11	7.8	20.5	5.5	1.296.0901.61
PG 11	M16 x 1.5		13.5	9.8	22	5.5	1.296.1101.61
PG 13.5	M20 x 1.5	NPT 1/2"	16	11.8	26.5	8	1.296.1301.61
PG 16	M20 x 1.5	NPT 1/2" / 16	18.5	13.8	28.8	9	1.296.1601.61
PG 21	M25 x 1.5	NPT 3/4"	22	17.8	32	11	1.296.2101.61
PG 29	M32 x 1.5	NPT 1" / NPT 1 1/4"	29	25	35.5	10	1.296.2901.61
PG 36	M40 x 1.5	NPT 1 1/2"	38	32	39	11	1.296.3601.61



to the assembly
instruction



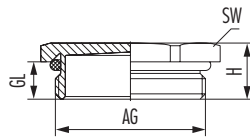

Material	Nickel-plated brass
Material o-ring	NBR
Protection class	IP 68 – 10 bar / IP 69 K
Ex-protection level	II 1D Ex ta IIC Da / II 2G Ex e IIC Gb
Temperature range	-20°C to +95°C

RoHS

AG	GL mm	H mm	SW mm	Item-No
M12 x 1.5	6.5	9.5	14	1.197.1200.50
M16 x 1.5	6	9	19	1.197.1600.50
M20 x 1.5	6	9.5	22	1.197.2000.50
M25 x 1.5	7	10.5	30	1.197.2500.50
M32 x 1.5	8	12.5	41	1.197.3200.50
M40 x 1.5	8	13	46	1.197.4000.50
M50 x 1.5	9	15	55	1.197.5000.50
M63 x 1.5	10	16.5	70	1.197.6300.50
PG 7	5	8	14	1.197.0700.01
PG 9	6	9	17	1.197.0900.01
PG 11	6	9.5	20	1.197.1100.01
PG 13.5	6.5	10	22	1.197.1300.01
PG 16	6.5	10	24	1.197.1600.01
PG 21	7	10.5	30	1.197.2100.01
PG 29	8	12.5	41	1.197.2900.01
PG 36	8	13	50	1.197.3600.01
PG 42	9	15	58	1.197.4200.01
PG 48	10	16.5	65	1.197.4800.01



to the assembly
instruction



Ex Accessories

Plug V-Ms-FKM-Ex (metric, PG)

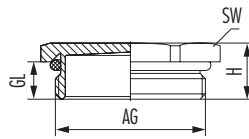

Material	Nickel-plated brass
Material o-ring	FKM
Protection class	IP 68 – 10 bar / IP 69 K
Ex-protection level	II 1D Ex ta IIIC Da / II 2G Ex e IIC Gb
Temperature range	-20°C to +180°C

RoHS

AG	GL mm	H mm	SW mm	Item-No
M12 x 1.5	6.5	9.5	14	1.198.1200.50
M16 x 1.5	6	9	19	1.198.1600.50
M20 x 1.5	6	9.5	22	1.198.2000.50
M25 x 1.5	7	10.5	30	1.198.2500.50
M32 x 1.5	8	12.5	41	1.198.3200.50
M40 x 1.5	8	13	46	1.198.4000.50
M50 x 1.5	9	15	55	1.198.5000.50
M63 x 1.5	10	16.5	70	1.198.6300.50
PG 7	5	8	14	1.198.0700.01
PG 9	6	9	17	1.198.0900.01
PG 11	6	9.5	20	1.198.1100.01
PG 13.5	6.5	10	22	1.198.1300.01
PG 16	6.5	10	24	1.198.1600.01
PG 21	7	10.5	30	1.198.2100.01
PG 29	8	12.5	41	1.198.2900.01
PG 36	8	13	50	1.198.3600.01
PG 42	9	15	58	1.198.4200.01
PG 48	10	16.5	65	1.198.4800.01



to the assembly
instruction



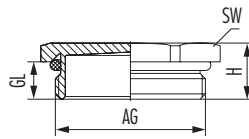

Material	Nickel-plated brass
Material o-ring	VMQ (silicone)
Protection class	IP 68 – 10 bar / IP 69 K
Ex-protection level	II 1D Ex ta IIIC Da / II 2G Ex e IIC Gb
Temperature range	-60°C to +180°C

RoHS

AG	GL mm	H mm	SW mm	Item-No
M12 x 1.5	6.5	9.5	14	1.199.1200.50
M16 x 1.5	6	9	19	1.199.1600.50
M20 x 1.5	6	9.5	22	1.199.2000.50
M25 x 1.5	7	10.5	30	1.199.2500.50
M32 x 1.5	8	12.5	41	1.199.3200.50
M40 x 1.5	8	13	46	1.199.4000.50
M50 x 1.5	9	15	55	1.199.5000.50
M63 x 1.5	10	16.5	70	1.199.6300.50
PG 7	5	8	14	1.199.0700.01
PG 9	6	9	17	1.199.0900.01
PG 11	6	9.5	20	1.199.1100.01
PG 13.5	6.5	10	22	1.199.1300.01
PG 16	6.5	10	24	1.199.1600.01
PG 21	7	10.5	30	1.199.2100.01
PG 29	8	12.5	41	1.199.2900.01
PG 36	8	13	50	1.199.3600.01
PG 42	9	15	58	1.199.4200.01
PG 48	10	16.5	65	1.199.4800.01



to the assembly
instruction



Ex Accessories

Plug V-Ms-Ex d (metric)

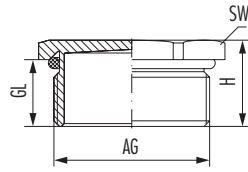

Material	Nickel-plated brass
Material o-ring	NBR
Protection class	IP 68 – 10 bar / IP 69 K
Ex-protection level	II 2G Ex db eb IIC Gb / II 1D Ex ta IIIC Da
Temperature range	-20°C to +95°C

RoHS

AG	GL mm	H mm	SW mm	Item-No
M12 x 1.5	16	21	14	1.875.1200.50
M16 x 1.5	16	20	19	1.875.1600.50
M20 x 1.5	16	19.5	22	1.875.2000.50
M25 x 1.5	16	19.5	30	1.875.2500.50
M32 x 1.5	16	20.5	41	1.875.3200.50
M40 x 1.5	16	21	46	1.875.4000.50
M50 x 1.5	16	22	55	1.875.5000.50
M63 x 1.5	16	22.5	70	1.875.6300.50



to the assembly
instruction



Plug V-Ms-FKM-Ex d (metric)

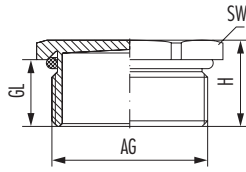

Material	Nickel-plated brass
Material o-ring	FKM
Protection class	IP 68 – 10 bar / IP 69 K
Ex-protection level	II 2G Ex db eb IIC Gb / II 1D Ex ta IIIC Da
Temperature range	-20°C to +180°C

RoHS

AG	GL mm	H mm	SW mm	Item-No
M12 x 1.5	16	21	14	1.876.1200.50
M16 x 1.5	16	20	19	1.876.1600.50
M20 x 1.5	16	19.5	22	1.876.2000.50
M25 x 1.5	16	19.5	30	1.876.2500.50
M32 x 1.5	16	20.5	41	1.876.3200.50
M40 x 1.5	16	21	46	1.876.4000.50
M50 x 1.5	16	22	55	1.876.5000.50
M63 x 1.5	16	22.5	70	1.876.6300.50



to the assembly instruction



Plug V-Ms-VMQ-Ex d (metric)

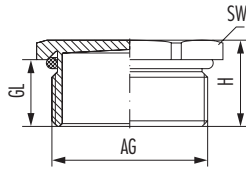

Material	Nickel-plated brass
Material o-ring	VMQ (silicone)
Protection class	IP 68 – 10 bar / IP 69 K
Ex-protection level	II 2G Ex db eb IIC Gb / II 1D Ex ta IIIC Da
Temperature range	-60°C to +180°C

RoHS

AG	GL mm	H mm	SW mm	Item-No
M12 x 1.5	16	21	14	1.877.1200.50
M16 x 1.5	16	20	19	1.877.1600.50
M20 x 1.5	16	19.5	22	1.877.2000.50
M25 x 1.5	16	19.5	30	1.877.2500.50
M32 x 1.5	16	20.5	41	1.877.3200.50
M40 x 1.5	16	21	46	1.877.4000.50
M50 x 1.5	16	22	55	1.877.5000.50
M63 x 1.5	16	22.5	70	1.877.6300.50



to the assembly
instruction



Plug V-Ms-Ex d (NPT)

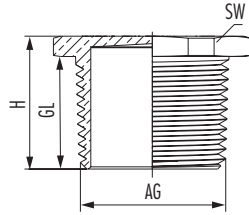

Material	Nickel-plated brass
Protection class	IP 68 – 10 bar / IP 69 K
Ex-protection level	II 2G Ex db eb IIC Gb / II 1D Ex ta IIIC Da

RoHS

AG	GL mm	H mm	SW mm	Item-No
NPT 3/8"	16	20	16	1.877.3800.70
NPT 1/2"	20	23.5	24	1.877.1200.70
NPT 3/4"	20.5	24	30	1.877.3400.70
NPT 1"	25	29.5	41	1.877.1000.70
NPT 1 1/4"	26	31	46	1.877.5400.70
NPT 1 1/2"	26.5	32.5	55	1.877.6400.70



to the assembly instruction



Ex Accessories

Plug V-INOX-Ex (metric, PG)

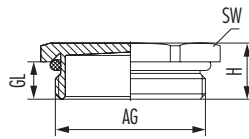

Material	INOX 1.4305
Material o-ring	NBR
Protection class	IP 68 – 10 bar / IP 69 K
Ex-protection level	II 1D Ex ta IIC Da / II 2G Ex e IIC Gb
Temperature range	-20°C to +95°C

RoHS

AG	GL mm	H mm	SW mm	Item-No
M12 x 1.5	6.5	9.5	14	1.192.1200.50
M16 x 1.5	6	9	19	1.192.1600.50
M20 x 1.5	6	9.5	22	1.192.2000.50
M25 x 1.5	7	10.5	30	1.192.2500.50
M32 x 1.5	8	12.5	41	1.192.3200.50
M40 x 1.5	8	13	46	1.192.4000.50
M50 x 1.5	9	15	55	1.192.5000.50
M63 x 1.5	10	16.5	70	1.192.6300.50
PG 7	5	8	14	1.192.0700.01
PG 9	6	9	17	1.192.0900.01
PG 11	6	9.5	20	1.192.1100.01
PG 13.5	6.5	10	22	1.192.1300.01
PG 16	6.5	10	24	1.192.1600.01
PG 21	7	10.5	30	1.192.2100.01
PG 29	8	12.5	41	1.192.2900.01
PG 36	8	13	50	1.192.3600.01
PG 42	9	15	58	1.192.4200.01
PG 48	10	16.5	65	1.192.4800.01



to the assembly
instruction



Plug V-INOX-FKM-Ex (metric, PG)

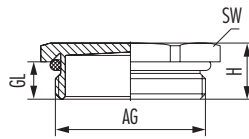

Material	INOX 1.4305
Material o-ring	FKM
Protection class	IP 68 – 10 bar / IP 69 K
Ex-protection level	II 1D Ex ta IIIC Da / II 2G Ex e IIC Gb
Temperature range	-20°C to +180°C

RoHS

AG	GL mm	H mm	SW mm	Item-No
M12 x 1.5	6.5	9.5	14	1.193.1200.50
M16 x 1.5	6	9	19	1.193.1600.50
M20 x 1.5	6	9.5	22	1.193.2000.50
M25 x 1.5	7	10.5	30	1.193.2500.50
M32 x 1.5	8	12.5	41	1.193.3200.50
M40 x 1.5	8	13	46	1.193.4000.50
M50 x 1.5	9	15	55	1.193.5000.50
M63 x 1.5	10	16.5	70	1.193.6300.50
PG 7	5	8	14	1.193.0700.01
PG 9	6	9	17	1.193.0900.01
PG 11	6	9.5	20	1.193.1100.01
PG 13.5	6.5	10	22	1.193.1300.01
PG 16	6.5	10	24	1.193.1600.01
PG 21	7	10.5	30	1.193.2100.01
PG 29	8	12.5	41	1.193.2900.01
PG 36	8	13	50	1.193.3600.01
PG 42	9	15	55	1.193.4200.01
PG 48	10	16.5	65	1.193.4800.01



to the assembly instruction



Ex Accessories

Plug V-INOX-VMQ-Ex (metric, PG)

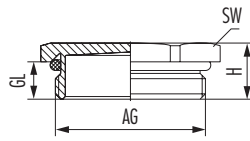

Material	INOX 1.4305
Material o-ring	VMQ (silicone)
Protection class	IP 68 – 10 bar / IP 69 K
Ex-protection level	II 1D Ex ta IIC Da / II 2G Ex e IIC Gb
Temperature range	-60°C to +180°C

RoHS

AG	GL mm	H mm	SW mm	Item-No
M12 x 1.5	6.5	9.5	14	1.194.1200.50
M16 x 1.5	6	9	19	1.194.1600.50
M20 x 1.5	6	9.5	22	1.194.2000.50
M25 x 1.5	7	10.5	30	1.194.2500.50
M32 x 1.5	8	12.5	41	1.194.3200.50
M40 x 1.5	8	13	46	1.194.4000.50
M50 x 1.5	9	15	55	1.194.5000.50
M63 x 1.5	10	16.5	70	1.194.6300.50
PG 7	5	8	14	1.194.0700.01
PG 9	6	9	17	1.194.0900.01
PG 11	6	9.5	20	1.194.1100.01
PG 13.5	6.5	10	22	1.194.1300.01
PG 16	6.5	10	24	1.194.1600.01
PG 21	7	10.5	30	1.194.2100.01
PG 29	8	12.5	41	1.194.2900.01
PG 36	8	13	50	1.194.3600.01
PG 42	9	15	58	1.194.4200.01
PG 48	10	16.5	65	1.194.4800.01



to the assembly
instruction



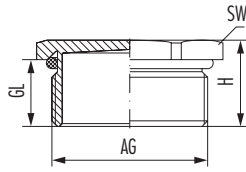

Material	INOX 1.4404
Material o-ring	NBR
Protection class	IP 68 – 10 bar / IP 69 K
Ex-protection level	II 2G Ex db eb IIC Gb / II 1D Ex ta IIIC Da
Temperature range	-20°C to +95°C

RoHS

AG	GL mm	H mm	SW mm	Item-No
M12 x 1.5	16	19	14	1.895.1200.50
M16 x 1.5	16	19	19	1.895.1600.50
M20 x 1.5	16	19.5	22	1.895.2000.50
M25 x 1.5	16	19.5	30	1.895.2500.50
M32 x 1.5	16	20.5	41	1.895.3200.50
M40 x 1.5	16	21	46	1.895.4000.50
M50 x 1.5	16	22	55	1.895.5000.50
M63 x 1.5	16	22.5	70	1.895.6300.50



to the assembly instruction



Plug V-INOX-FKM-Ex d (metric)

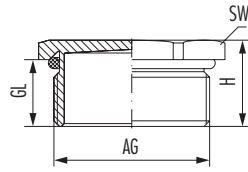

Material	INOX 1.4404
Material o-ring	FKM
Protection class	IP 68 – 10 bar / IP 69 K
Ex-protection level	II 2G Ex db eb IIC Gb / II 1D Ex ta IIIC Da
Temperature range	-20°C to +180°C

RoHS

AG	GL mm	H mm	SW mm	Item-No
M12 x 1.5	16	19	14	1.896.1200.50
M16 x 1.5	16	19	19	1.896.1600.50
M20 x 1.5	16	19.5	22	1.896.2000.50
M25 x 1.5	16	19.5	30	1.896.2500.50
M32 x 1.5	16	20.5	41	1.896.3200.50
M40 x 1.5	16	21	46	1.896.4000.50
M50 x 1.5	16	22	55	1.896.5000.50
M63 x 1.5	16	22.5	70	1.896.6300.50



to the assembly
instruction



Plug V-INOX-VMQ-Ex d (metric)

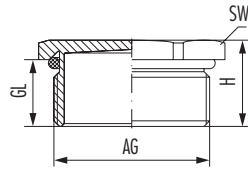

Material	INOX 1.4404
Material o-ring	VMQ (silicone)
Protection class	IP 68 – 10 bar / IP 69 K
Ex-protection level	II 2G Ex db eb IIC Gb / II 1D Ex ta IIIC Da
Temperature range	-60°C to +180°C

RoHS

AG	GL mm	H mm	SW mm	Item-No
M12 x 1.5	16	19	14	1.897.1200.50
M16 x 1.5	16	19	19	1.897.1600.50
M20 x 1.5	16	19.5	22	1.897.2000.50
M25 x 1.5	16	19.5	30	1.897.2500.50
M32 x 1.5	16	20.5	41	1.897.3200.50
M40 x 1.5	16	21	46	1.897.4000.50
M50 x 1.5	16	22	55	1.897.5000.50
M63 x 1.5	16	22.5	70	1.897.6300.50



to the assembly instruction



Plug V-INOX-Ex d (NPT)

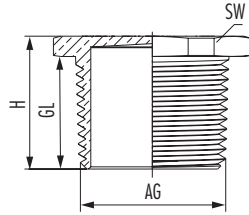

Material	INOX 1.4404
Protection class	IP 68 – 10 bar / IP 69 K
Ex-protection level	II 2G Ex db eb IIC Gb / II 1D Ex ta IIIC Da

RoHS

AG	GL mm	H mm	SW mm	Item-No
NPT 3/8"	16	20	16	1.897.3800.70
NPT 1/2"	20	23.5	24	1.897.1200.70
NPT 3/4"	20.5	24	30	1.897.3400.70
NPT 1"	25	29.5	41	1.897.1000.70
NPT 1 1/4"	26	31	46	1.897.5400.70
NPT 1 1/2"	26.5	32.5	55	1.897.6400.70



to the assembly instruction



Adapter RSD-MS-Ex (metric, PG)

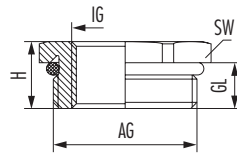

Material	Nickel-plated brass
Material o-ring	NBR
Protection class	IP 68 – 10 bar / IP 69 K
Ex-protection level	II 2G Ex eb IIC Gb / II 1D Ex ta IIIC Da
Temperature range	-20°C to +95°C

RoHS

AG	IG	GL mm	H mm	SW mm	Item-No
M16 x 1.5	M12 x 1.5	5	8	17	1.078.1612.50
M20 x 1.5	M12 x 1.5	6	9	22	1.078.2012.50
M20 x 1.5	M16 x 1.5	6	9	22	1.078.2016.50
M25 x 1.5	M16 x 1.5	7	10	29	1.078.2516.50
M25 x 1.5	M20 x 1.5	7	10	29	1.078.2520.50
M32 x 1.5	M16 x 1.5	8	11	34	1.078.3216.50
M32 x 1.5	M20 x 1.5	8	11	34	1.078.3220.50
M32 x 1.5	M25 x 1.5	8	11	34	1.078.3225.50
M40 x 1.5	M20 x 1.5	8	12	43	1.078.4020.50
M40 x 1.5	M25 x 1.5	8	12	43	1.078.4025.50
M40 x 1.5	M32 x 1.5	8	12	43	1.078.4032.50
M50 x 1.5	M25 x 1.5	9	13	55	1.078.5025.50
M50 x 1.5	M32 x 1.5	9	13	55	1.078.5032.50
M50 x 1.5	M40 x 1.5	9	13	55	1.078.5040.50
M63 x 1.5	M32 x 1.5	10	14	65	1.078.6332.50
M63 x 1.5	M40 x 1.5	10	14	65	1.078.6340.50
M63 x 1.5	M50 x 1.5	10	14	65	1.078.6350.50
PG 9	PG 7	6	8.8	17	1.078.0907.01
PG 11	PG 7	6	9	20	1.078.1107.01
PG 11	PG 9	6	9	20	1.078.1109.01
PG 13.5	PG 9	6.5	9.5	22	1.078.1309.01
PG 16	PG 9	6.5	9.5	24	1.078.1609.01
PG 16	PG 11	6.5	9.5	24	1.078.1611.01
PG 16	PG 13.5	6.5	9.5	24	1.078.1613.01
PG 21	PG 11	7	10.3	30	1.078.2111.01
PG 21	PG 13.5	7	10.3	30	1.078.2113.01
PG 21	PG 16	7	10.3	30	1.078.2116.01
PG 29	PG 16	8	11.5	40	1.078.2916.01
PG 29	PG 21	8	11.5	40	1.078.2921.01
PG 36	PG 21	9	12.5	50	1.078.3621.01
PG 36	PG 29	9	12.5	50	1.078.3629.01
PG 42	PG 29	10	13.5	57	1.078.4229.01
PG 42	PG 36	10	13.5	57	1.078.4236.01
PG 48	PG 36	10	13.5	64	1.078.4836.01
PG 48	PG 42	10	13.5	64	1.078.4842.01



to the assembly
instruction



Ex Accessories

Adapter RSD-MS-VMQ-Ex (metric, PG)

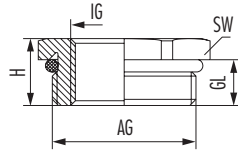

Material	Nickel-plated brass
Material o-ring	VMQ (silicone)
Protection class	IP 68 – 10 bar / IP 69 K
Ex-protection level	II 2G Ex eb IIC Gb / II 1D Ex ta IIIC Da
Temperature range	-60°C to +180°C

RoHS

AG	IG	GL mm	H mm	SW mm	Item-No
M16 x 1.5	M12 x 1.5	5	8	17	1.079.1612.50
M20 x 1.5	M12 x 1.5	6	9	22	1.079.2012.50
M20 x 1.5	M16 x 1.5	6	9	22	1.079.2016.50
M25 x 1.5	M16 x 1.5	7	10	29	1.079.2516.50
M25 x 1.5	M20 x 1.5	7	10	29	1.079.2520.50
M32 x 1.5	M16 x 1.5	8	11	34	1.079.3216.50
M32 x 1.5	M20 x 1.5	8	11	34	1.079.3220.50
M32 x 1.5	M25 x 1.5	8	11	34	1.079.3225.50
M40 x 1.5	M20 x 1.5	8	12	43	1.079.4020.50
M40 x 1.5	M25 x 1.5	8	12	43	1.079.4025.50
M40 x 1.5	M32 x 1.5	8	12	43	1.079.4032.50
M50 x 1.5	M25 x 1.5	9	13	55	1.079.5025.50
M50 x 1.5	M32 x 1.5	9	13	55	1.079.5032.50
M50 x 1.5	M40 x 1.5	9	13	55	1.079.5040.50
M63 x 1.5	M32 x 1.5	10	14	65	1.079.6332.50
M63 x 1.5	M40 x 1.5	10	14	65	1.079.6340.50
M63 x 1.5	M50 x 1.5	10	14	65	1.079.6350.50
PG 9	PG 7	6	8.8	17	1.079.0907.01
PG 11	PG 7	6	9	20	1.079.1107.01
PG 11	PG 9	6	9	20	1.079.1109.01
PG 13.5	PG 9	6.5	9.5	22	1.079.1309.01
PG 16	PG 9	6.5	9.5	24	1.079.1609.01
PG 16	PG 11	6.5	9.5	24	1.079.1611.01
PG 16	PG 13.5	6.5	9.5	24	1.079.1613.01
PG 21	PG 11	7	10.3	30	1.079.2111.01
PG 21	PG 13.5	7	10.3	30	1.079.2113.01
PG 21	PG 16	7	10.3	30	1.079.2116.01
PG 29	PG 16	8	11.5	40	1.079.2916.01
PG 29	PG 21	8	11.5	40	1.079.2921.01
PG 36	PG 21	9	12.5	50	1.079.3621.01
PG 36	PG 29	9	12.5	50	1.079.3629.01
PG 42	PG 29	10	13.5	57	1.079.4229.01
PG 42	PG 36	10	13.5	57	1.079.4236.01
PG 48	PG 36	10	13.5	64	1.079.4836.01
PG 48	PG 42	10	13.5	64	1.079.4842.01



to the assembly
instruction



Adapter RSD-MS-Ex d (metric)

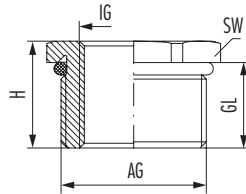

Material	Nickel-plated brass
Material o-ring	NBR
Protection class	IP 68 – 10 bar / IP 69 K
Ex-protection level	II 2G Ex db eb IIC Gb / II 1D Ex ta IIIC Da
Temperature range	-20°C to +95°C

RoHS

AG	IG	GL mm	H mm	SW mm	Item-No
M16 x 1.5	M12 x 1.5	16	19	19	1.878.1612.50
M20 x 1.5	M12 x 1.5	16	19.5	22	1.878.2012.50
M20 x 1.5	M16 x 1.5	16	19.5	22	1.878.2016.50
M25 x 1.5	M16 x 1.5	16	19.5	30	1.878.2516.50
M25 x 1.5	M20 x 1.5	16	19.5	30	1.878.2520.50
M32 x 1.5	M16 x 1.5	16	20.5	41	1.878.3216.50
M32 x 1.5	M20 x 1.5	16	20.5	41	1.878.3220.50
M32 x 1.5	M25 x 1.5	16	20.5	41	1.878.3225.50
M40 x 1.5	M20 x 1.5	16	21	46	1.878.4020.50
M40 x 1.5	M25 x 1.5	16	21	46	1.878.4025.50
M40 x 1.5	M32 x 1.5	16	21	46	1.878.4032.50
M50 x 1.5	M25 x 1.5	16	21	55	1.878.5025.50
M50 x 1.5	M32 x 1.5	16	21	55	1.878.5032.50



to the assembly instruction



Adapter RSD-MS-VMQ-Ex d (metric)

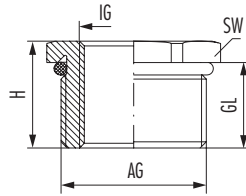

Material	Nickel-plated brass
Material o-ring	VMQ (silicone)
Protection class	IP 68 – 10 bar / IP 69 K
Ex-protection level	II 2G Ex db eb IIC Gb / II 1D Ex ta IIIC Da
Temperature range	-60°C to +180°C

RoHS

AG	IG	GL mm	H mm	SW mm	Item-No
M16 x 1.5	M12 x 1.5	16	19	19	1.879.1612.50
M20 x 1.5	M12 x 1.5	16	19.5	22	1.879.2012.50
M20 x 1.5	M16 x 1.5	16	19.5	22	1.879.2016.50
M25 x 1.5	M16 x 1.5	16	19.5	30	1.879.2516.50
M25 x 1.5	M20 x 1.5	16	19.5	30	1.879.2520.50
M32 x 1.5	M16 x 1.5	16	20.5	41	1.879.3216.50
M32 x 1.5	M20 x 1.5	16	20.5	41	1.879.3220.50
M32 x 1.5	M25 x 1.5	16	20.5	41	1.879.3225.50
M40 x 1.5	M20 x 1.5	16	21	46	1.879.4020.50
M40 x 1.5	M25 x 1.5	16	21	46	1.879.4025.50
M40 x 1.5	M32 x 1.5	16	21	46	1.879.4032.50
M50 x 1.5	M25 x 1.5	16	21	55	1.879.5025.50
M50 x 1.5	M32 x 1.5	16	21	55	1.879.5032.50



to the assembly
instruction



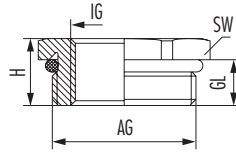

Material	INOX 1.4305
Material o-ring	NBR
Protection class	IP 68 – 10 bar / IP 69 K
Ex-protection level	II 1D Ex ta IIC Da / II 2G Ex e IIC Gb
Temperature range	-20°C to +95°C

RoHS

AG	IG	GL mm	H mm	SW mm	Item-No
M16 x 1.5	M12 x 1.5	5	15	19	1.098.1612.50
M20 x 1.5	M12 x 1.5	6	15.5	22	1.098.2012.50
M20 x 1.5	M16 x 1.5	6	15.5	22	1.098.2016.50
M25 x 1.5	M16 x 1.5	7	15.5	30	1.098.2516.50
M25 x 1.5	M20 x 1.5	7	15.5	30	1.098.2520.50
M32 x 1.5	M16 x 1.5	8	16.5	41	1.098.3216.50
M32 x 1.5	M20 x 1.5	8	12.5	41	1.098.3220.50
M32 x 1.5	M25 x 1.5	8	12.5	41	1.098.3225.50
M40 x 1.5	M20 x 1.5	8	17	46	1.098.4020.50
M40 x 1.5	M25 x 1.5	8	17	46	1.098.4025.50
M40 x 1.5	M32 x 1.5	8	17	46	1.098.4032.50
M50 x 1.5	M25 x 1.5	9	13.5	55	1.098.5025.50
M50 x 1.5	M32 x 1.5	9	13.5	55	1.098.5032.50
M50 x 1.5	M40 x 1.5	9	13.5	55	1.098.5040.50
M63 x 1.5	M32 x 1.5	10	16.5	65	1.098.6332.50
M63 x 1.5	M40 x 1.5	10	16.5	65	1.098.6340.50
M63 x 1.5	M50 x 1.5	10	16.5	65	1.098.6350.50
PG 9	PG 7	6	8.8	17	1.098.0907.01
PG 11	PG 7	6	9	20	1.098.1107.01
PG 11	PG 9	6	9	20	1.098.1109.01
PG 13.5	PG 9	6.5	9.5	22	1.098.1309.01
PG 13.5	PG 11	6.5	9.5	22	1.098.1311.01
PG 16	PG 9	6.5	9.5	24	1.098.1609.01
PG 16	PG 11	6.5	9.5	24	1.098.1611.01
PG 16	PG 13.5	6.5	9.5	24	1.098.1613.01
PG 21	PG 11	7	10.3	30	1.098.2111.01
PG 21	PG 13.5	7	10.3	30	1.098.2113.01
PG 21	PG 16	7	10.3	30	1.098.2116.01
PG 29	PG 16	8	11.5	40	1.098.2916.01
PG 29	PG 21	8	11.5	40	1.098.2921.01
PG 36	PG 21	9	12.5	50	1.098.3621.01
PG 36	PG 29	9	12.5	50	1.098.3629.01
PG 42	PG 29	10	13.5	57	1.098.4229.01
PG 42	PG 36	10	13.5	57	1.098.4236.01
PG 48	PG 36	10	13.5	64	1.098.4836.01
PG 48	PG 42	10	13.5	64	1.098.4842.01



to the assembly instruction



Ex Accessories

Plug RSD-INOX-VMQ-Ex (metric, PG)

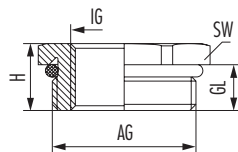

Material	INOX 1.4305
Material o-ring	VMQ (silicone)
Protection class	IP 68 – 10 bar / IP 69 K
Ex-protection level	II 1D Ex ta IIIC Da / II 2G Ex e IIC Gb
Temperature range	-60°C to +180°C

RoHS

AG	IG	GL mm	H mm	SW mm	Item-No
M16 x 1.5	M12 x 1.5	5	9	19	1.099.1612.50
M20 x 1.5	M12 x 1.5	6	9.5	22	1.099.2012.50
M20 x 1.5	M16 x 1.5	6	9.5	22	1.099.2016.50
M25 x 1.5	M16 x 1.5	7	10.5	30	1.099.2516.50
M25 x 1.5	M20 x 1.5	7	10.5	30	1.099.2520.50
M32 x 1.5	M16 x 1.5	8	12.5	41	1.099.3216.50
M32 x 1.5	M20 x 1.5	8	12.5	41	1.099.3220.50
M32 x 1.5	M25 x 1.5	8	12.5	41	1.099.3225.50
M40 x 1.5	M20 x 1.5	8	13	46	1.099.4020.50
M40 x 1.5	M25 x 1.5	8	13	46	1.099.4025.50
M40 x 1.5	M32 x 1.5	8	13	46	1.099.4032.50
M50 x 1.5	M25 x 1.5	9	13.5	55	1.099.5025.50
M50 x 1.5	M32 x 1.5	9	13.5	55	1.099.5032.50
M50 x 1.5	M40 x 1.5	9	13.5	55	1.099.5040.50
M63 x 1.5	M32 x 1.5	10	16.5	65	1.099.6332.50
M63 x 1.5	M40 x 1.5	10	16.5	65	1.099.6340.50
M63 x 1.5	M50 x 1.5	10	16.5	65	1.099.6350.50
PG 9	PG 7	6	8.8	17	1.099.0907.01
PG 11	PG 7	6	9	20	1.099.1107.01
PG 11	PG 9	6	9	20	1.099.1109.01
PG 13.5	PG 9	6.5	9.5	22	1.099.1309.01
PG 13.5	PG 11	6.5	9.5	22	1.099.1311.01
PG 16	PG 9	6.5	9.5	24	1.099.1609.01
PG 16	PG 11	6.5	9.5	24	1.099.1611.01
PG 16	PG 13.5	6.5	9.5	24	1.099.1613.01
PG 21	PG 11	7	10.3	30	1.099.2111.01
PG 21	PG 13.5	7	10.3	30	1.099.2113.01
PG 21	PG 16	7	10.3	30	1.099.2116.01
PG 29	PG 16	8	11.5	40	1.099.2916.01
PG 29	PG 21	8	11.5	40	1.099.2921.01
PG 36	PG 21	9	12.5	50	1.099.3621.01
PG 36	PG 29	9	12.5	50	1.099.3629.01
PG 42	PG 29	10	13.5	57	1.099.4229.01
PG 42	PG 36	10	13.5	57	1.099.4236.01
PG 48	PG 36	10	13.5	64	1.099.4836.01
PG 48	PG 42	10	13.5	64	1.099.4842.01



to the assembly instruction



Adapter RSD-INOX-Ex d (metric)

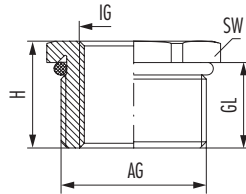

Material	INOX 1.4404
Material o-ring	NBR
Protection class	IP 68 – 10 bar / IP 69 K
Ex-protection level	II 2G Ex db eb IIC Gb / II 1D Ex ta IIIC Da
Temperature range	-20°C to +95°C

RoHS

AG	IG	GL mm	H mm	SW mm	Item-No
M16 x 1.5	M12 x 1.5	16	19	19	1.898.1612.50
M20 x 1.5	M12 x 1.5	16	19.5	22	1.898.2012.50
M20 x 1.5	M16 x 1.5	16	19.5	22	1.898.2016.50
M25 x 1.5	M16 x 1.5	16	19.5	30	1.898.2516.50
M25 x 1.5	M20 x 1.5	16	19.5	30	1.898.2520.50
M32 x 1.5	M16 x 1.5	16	20.5	41	1.898.3216.50
M32 x 1.5	M20 x 1.5	16	20.5	41	1.898.3220.50
M32 x 1.5	M25 x 1.5	16	20.5	41	1.898.3225.50
M40 x 1.5	M20 x 1.5	16	21	46	1.898.4020.50
M40 x 1.5	M25 x 1.5	16	21	46	1.898.4025.50
M40 x 1.5	M32 x 1.5	16	21	46	1.898.4032.50



to the assembly instruction



Adapter RSD-INOX-VMQ-Ex d (metric)

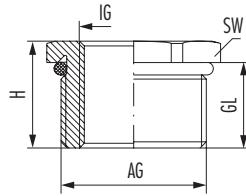

Material	INOX 1.4404
Material o-ring	VMQ (silicone)
Protection class	IP 68 – 10 bar / IP 69 K
Ex-protection level	II 2G Ex db eb IIC Gb / II 1D Ex ta IIIC Da
Temperature range	-60°C to +180°C

RoHS

AG	IG	GL mm	H mm	SW mm	Item-No
M16 x 1.5	M12 x 1.5	16	19	19	1.899.1612.50
M20 x 1.5	M12 x 1.5	16	19.5	22	1.899.2012.50
M20 x 1.5	M16 x 1.5	16	19.5	22	1.899.2016.50
M25 x 1.5	M16 x 1.5	16	19.5	30	1.899.2516.50
M25 x 1.5	M20 x 1.5	16	19.5	30	1.899.2520.50
M32 x 1.5	M16 x 1.5	16	20.5	41	1.899.3216.50
M32 x 1.5	M20 x 1.5	16	20.5	41	1.899.3220.50
M32 x 1.5	M25 x 1.5	16	20.5	41	1.899.3225.50
M40 x 1.5	M20 x 1.5	16	21	46	1.899.4020.50
M40 x 1.5	M25 x 1.5	16	21	46	1.899.4025.50
M40 x 1.5	M32 x 1.5	16	21	46	1.899.4032.50



to the assembly
instruction

